

U.S.C.G. FAMILY HOUSING

A certain parcel of land located in the City of Weymouth, County of Norfolk, Commonwealth of Massachusetts, shown as "U.S.C.G. Family Housing" on a plan entitled "Property Boundary Survey (F.O.S.T No.1 and No.2), Naval Air Station, South Weymouth, MA", prepared by Surveying and Mapping Consultants, Inc., dated April ??, 2003, recorded herewith (the "Plan"), more particularly bounded and described as follows:

Beginning at a point near a concrete bound with a drill hole at the northwesterly corner of the herein described parcel as shown on the Plan, thence

N 41-28-04 E by Parcel FP1-1A, as shown on the Plan, a distance of 1160.61 feet to a point, thence

S 25-20-01 E by land shown on the Plan as now or formerly of Douglas P. and Lisa A. Folsom, Wayne A. and Kimberly J. Buscemi, Mark L. and Lisa S. Trainor and Robert R. Schleiff, a distance of 384.00 feet to a point, thence

S 31-23-58 E by land shown on the Plan as now or formerly of Robert R. Schleiff, Peter and Virginia M. Rose, Beatrice and Edward G. Croke, Marsha L. Bryant, Charles W. Lufkin and Vincent L. and Marie A. Jankord, a distance of 553.94 feet to a point, thence

S 32-43-26 E by land shown on the Plan as now or formerly of Vincent L. and Marie A. Jankord, Allan C., Steven D. and Allan R. Sloane, Allison Delisle, James F. Gallahue, III, Ronald R. Reed, John A. and Laura A. Bartolomeo and Stephen Gregg and Roberta Ferguson-Gregg, a distance of 548.09 feet to a point, thence

S 12-32-58 E by land shown on the Plan as now or formerly of Town of Weymouth, a distance of 141.26 feet to a point, thence

S 39-10-29 E by land shown on the Plan as now or formerly of John and Deborah Thompson and Joseph R. and Michael M. Cowan, a distance of 1031.32 feet to a point, thence

N 83-29-23 E by said Cowan land, a distance of 144.83 feet to a point, thence

N 81-10-41 E by the same, a distance of 78.50 feet to a point, thence

S 16-19-09 E by land shown on the Plan as now or formerly of Edward A. Scigliano and Anita Stranberg and William J. and Marie E. Kerrigan, a distance of 293.29 feet to a point, thence

S 88-41-48 W by Parcel FP1-5, as shown on the Plan, a distance of 635.47 feet to a point, thence

S 84-41-53 W by the same and by other land of the grantor, a distance of 783.64 feet to a point near a concrete bound with a drill hole, thence

Northwesterly by Parcel FE2-1B, as shown on the Plan, along a curve to the left having a radius of 1650.00 feet and an arc length of 1079.89 feet to a steel survey marker, thence

Northwesterly by the same and by Parcel FEI-1A, as shown on the Plan, along a curve to the left of radius 1650.00 feet and an arc length of 1079.89 feet to the point of beginning, said parcel contains 2,191,792 square feet or 50.317 acres, more or less, according to the Plan.

1212942.2

U.S.C.G. FAMILY HOUSING MAINTENANCE SITE

A certain parcel of land located in the City of Weymouth, County of Norfolk, Commonwealth of Massachusetts, shown as "U.S.C.G. Family Housing Maintenance" on a plan entitled "Property Boundary Survey (F.O.S.T No.1 & No.2), Naval Air Station, South Weymouth, MA", prepared by Surveying and Mapping Consultants, Inc., dated April ??, 2003, recorded herewith (the "Plan"), more particularly bounded and described as follows:

Beginning at the southeasterly corner of the herein described parcel, thence

N 89-58-05 W by other land of the Grantor, a distance of 237.00 feet to a point, thence

N 00-01-55 E by the same and by Parcel FEI-5, as shown on a plan, a distance of 150.00 feet to a point, thence

S 89-03-45 E by said Parcel FEI-5, a distance of 217.95 feet to a point, thence

S 07-23-05 E by the same and by other land of the grantor, a distance of 147.79 feet to the point of beginning, said parcel contains 33,711 square feet or 0.774 acres, more or less, according to the Plan.

1212943.2

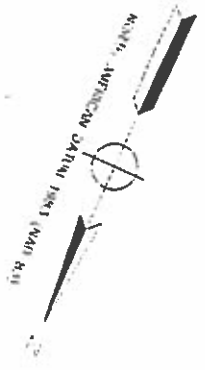
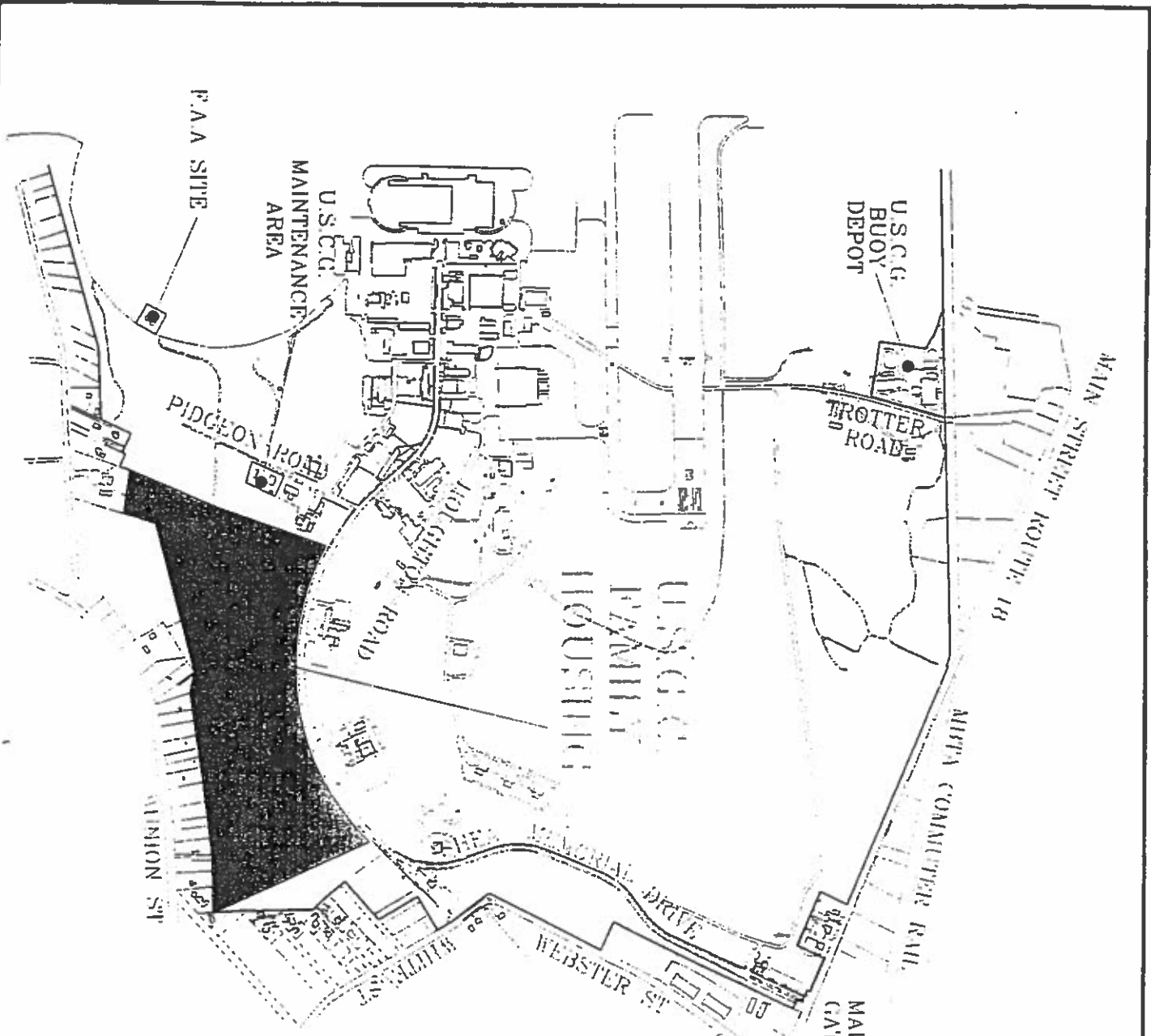

140 LONG'S ROAD
 SUITE 200
 QUANTICO MA 02144
 (508) 330-7265
 FAX (508) 330-7270
SMC SURVEYING AND DESIGN CONSULTANTS

EASEMENT PLAN
N.A.S. SOUTH WEYMOUTH
WEYMOUTH, MA

PROJECT FILE: EIR; MATTER, McCLENNIN & LEAH, LLP

SCALE: 1" = 100' DATE: APRIL 14, 2003
 SHEET NO. 1011010001/1011010001.dwg 1 OF 1

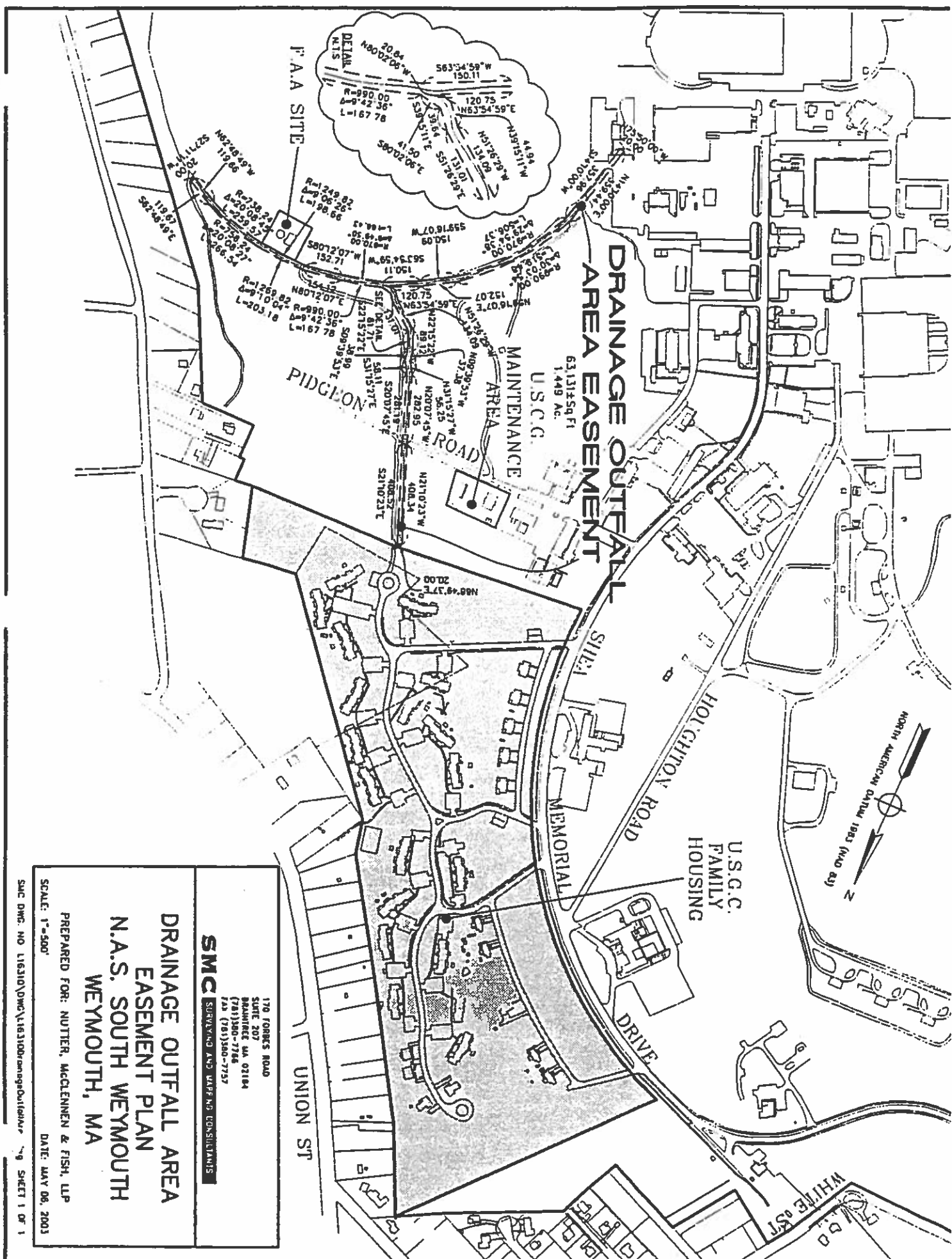

SMC SURVEYING AND MAPS AND CONSULTANTS

170 FORBES ROAD
 SUITE 207
 DANVERS MA 01924
 (781)350-7766
 FAX (781)350-7757

**DRAINAGE OUTFALL AREA
 EASEMENT PLAN**

**N.A.S. SOUTH WEYMOUTH
 WEYMOUTH, MA**

PREPARED FOR: NUTTER, MCGLENNEN & FISH, LLP
 DATE: MAY 08, 2003

SCALE: 1"=500'

SAC DWG. NO 116310\DWG\116310\drainageOutfall\dwg SHEET 1 OF 1