

Niagara Mohawk Power = 2.08 Acres
 NL Industries, Inc. = 9.21 Acres

THE UNITED STATES OF AMERICA
 Book 2256 Page 590
 Parcel No. 1
 Tax Map No. 53.11-1-14
 SEE MAP REFERENCE NO. 1
 AREA = 2.08 ACRES
 OR 90,809.45 SQ. FT.

AREA = 9.21 ± ACRES
 TOTAL AREA = 11.29 ± ACRES

BOUNDARY DESCRIPTION

All that certain tract, piece or parcel of land situate, lying and being in the Town of Colonie, County of Albany, State of New York, lying Southwest of Central Avenue, and being more particularly bounded and described as follows:

BEGINNING at the point of intersection of the Southwesterly boundary of Central Avenue 99 foot wide right-of-way with the division line between the lands of The United States of America as described in Book 2256 of Deeds at Page 590 on the Northwest and the lands now or formerly of Edge of Woods Holding Group, Ltd. as described in Book 2648 of Deeds at Page 826 on the Southeast and runs thence from said point of beginning South 49 deg. 50 min. 56 sec. West along the above mentioned division line 154.71 feet to the point of intersection of the common division line between the lands of The United States of America on the Southwest and the lands now or formerly of Edge of Woods Holding Group, Ltd. as described in Book 2648 of Deeds at Page 826 and lands now or formerly of MBF Management Corporation as described in Book 2865 of Deeds at Page 977 on the Northeast; thence North 40 deg. 09 min. 04 sec. East along the above last mentioned common division line 282.62 feet to the point of intersection of the division line between the lands of the United States of America on the Northwest and the lands now or formerly of Donald Grimm as described in Book 2673 of Deeds at Page 237 on the Southeast; thence South 47 deg. 15 min. 51 sec. West along the above last mentioned division line 125.43 feet to the point of intersection of the division line between the lands of The United States of America on the North and the lands formerly of New York Central Railroad lands now or formerly of Consolidated Rail Corporation on the South said division line being the municipal division line between the Town of Colonie on the North and the City of Albany on the South; thence North 76 deg. 51 min. 24 sec. West along the above last mentioned division line 1,130.65 feet to the point of intersection of the common division line between the lands of The United States of America as described in Book 2268 of Deeds at Page 141 on the Southeast and the lands now or formerly of Hadi Ipek and Havzi Ipek as described in Book 2835 of Deeds at Page 760 and lands now or formerly of the Town of Colonie on the Northwest; thence North 49 deg. 00 min. 32 sec. East along the above last mentioned common division line 507.01 feet to its intersection with the common division line between the lands of The United States of America as described in Book 2268 of Deeds at Page 141 on the Southeast and the lands now or formerly of TM Enterprises of Albany, LLC on the Northwest; thence along the above last mentioned division line the following seven (7) courses: 1) South 30 deg. 34 min. 41 sec. East 101.44 feet to a point; 2) thence North 49 deg. 46 min. 29 sec. East 25.00 feet to a point; 3) thence South 40 deg. 13 min. 31 sec. East 50.00 feet to a point; 4) thence North 49 deg. 46 min. 29 sec. East 4.00 feet to a point; 5) thence South 16 deg. 32 min. 41 sec. East 45.58 feet to a point; 6) thence North 49 deg. 48 min. 29 sec. East 17.33 feet to a point; and 7) thence South 24 deg. 18 min. 21 sec. East 36.35 feet to its intersection with the division line between the lands of The United States of America on the Southeast and the lands now or formerly of TM Enterprises of Albany, LLC on the Northwest; thence North 49 deg. 42 min. 29 sec. East along the above last mentioned division line 207.73 feet to a point at the intersection of the division line between the lands of The United States of America as described in Book 2268 of Deeds at Page 141 and Book 2256 of Deeds at Page 590 on the Southwest and the lands now or formerly of Niagara Mohawk Power Corporation as described in Book 915 of Deeds at Page 251 on the Northeast; thence South 40 deg. 18 min. 04 sec. East along the above last mentioned division line 209.56 feet to the point of intersection of the division line between the lands of The United States of America on the Southeast and the lands now or formerly of Niagara Mohawk Power Corporation on the Northwest; thence North 49 deg. 41 min. 56 sec. East along the above last mentioned division line 169.59 feet to the intersection with the above mentioned Southwesterly boundary of Central Avenue; thence South 40 deg. 12 min. 14 sec. East along the Southwesterly boundary of Central Avenue 385.26 to the point or place of beginning and containing 11.29 acres of land, more or less.

- MAP NOTES:**
- Boundary information shown hereon was compiled from an actual field survey as shown on map reference no. one and field updated on September 2, 2016.
 - North orientation and bearings are referenced to Grid North and are based on the New York State Plane Coordinate System, East Zone, NAD 83/2011 epoch 2010.00.
 - Vertical datum shown hereon is NAVD 88 (Geoid 12A) and was obtained from GPS observations which were post processed holding Cobleskill and Saratoga CORS.
 - This survey was prepared without the benefit of an up to date abstract of title or title report and is therefore subject to any easements, covenants, restrictions or any statement of fact that such documents may disclose.
 - Parcel is subject to a nonplottable 10 foot wide right of way and easement for communication lines along the southerly side of Central Avenue granted by NL Industries, Inc. to New York Telephone Company and recorded January 24, 1984 in Book 2254 of Deeds at Page 849.
 - Lands conveyed NL Industries, Inc. to The United States of America in Book 2256 of Deeds at Page 590 are recited as being subject to an unrecorded easement to the Town of Colonie for drainage facilities and corridor for the same, an unrecorded easement to New York Telephone Company for conduit and manholes and an unrecorded license to New York Telephone Company for the storage of soils.
 - Lands conveyed by Niagara Mohawk Power Corporation to The United States of America in Book 2268 of Deeds at Page 141 are recited as being subject to the reservation for the right and easement for the transmission and distribution of electricity, the reservation of all existing transmission towers, lines and associated equipment presently located on the described property and recited as being subject to a fencing and drainage easement dated June 6, 1973 between the grantor and the Town of Colonie.

- MAP REFERENCES:**
- "Boundary Survey Lands of The United States of America 1130 Central Avenue", prepared by C.T. Male Associates, P.C., dated September 14, 2007, project no. 07.7520, DWG. No. 07-651.
 - "Deed Restriction Areas Colonie FUSRAP Site 1130 Central Avenue Albany, New York 12205", prepared by C.T. Male Associates, P.C., dated July 9, 2008, project no. 99.5377, DWG. No. 08-432.
 - "Survey Portion of Lands of N.L. Industries, Inc." prepared by C.T. Male Associates, P.C., dated September 3, 1982, MAP No. 82-166R.
 - "Environmental Easement Survey Lands of The United States of America 1130 Central Avenue", prepared by C.T. Male Associates, D.P.C., dated September 2, 2016, last revised August 21, 2017, project no. 15.5628, DWG. No. 16-545.
 - "U.S. Army Corps of Engineers Formerly Utilized Sites Remedial Action Program, Proposed Limits of Northlawn Remediation 10/2003 Colonie FUSRAP Site 1130 Central Avenue, Albany, NY 12205", prepared by Shaw Environmental, Inc., dated November 5, 2003, Drawing No. 837935D4.
 - "Proposed Easement Lands Now or Formerly of National Lead Company To Be Granted To The Town of Colonie", prepared by C.T. Male Associates, P.C., dated July 30, 1974, Map No. 72-386 3/6.

I certify to the following that this survey has been prepared in accordance with the Code of Practice for Land Surveys adopted by the N.Y.S. Association of Professional Land Surveyors as last revised.

The People of The State of New York, acting through their Commissioner of the Department of Environmental Conservation
 The United States of America

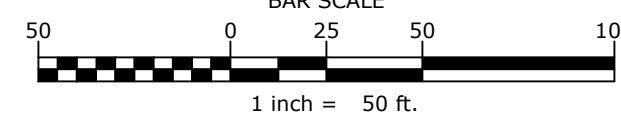

Carl M. Rigdon, P.L.S. No. 50711 Date

DATE	REVISIONS RECORD/DESCRIPTION	DRAFTER	CHECK	APPR.
8/21/17	REVISED TITLE	GLB	CMR	WJN
02/23/18	ADDED FORMER DEED LINES AND EASEMENT LABELS	GLB	DGD	WJN

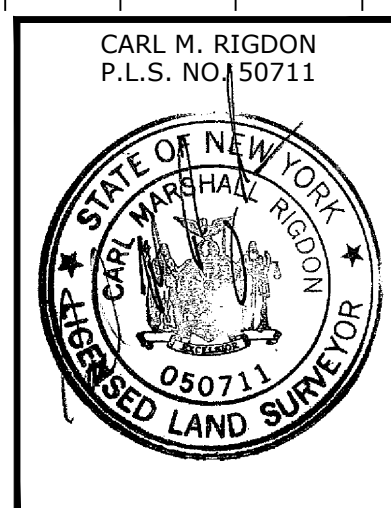

UNAUTHORIZED ALTERATION OR ADDITION TO THIS DOCUMENT IS A VIOLATION OF SECTION 209 SUBDIVISION 2 OF THE NEW YORK STATE EDUCATION LAW.

© 2016
 C.T. MALE ASSOCIATES, P.C.

APPROVED: WJN

DRAFTED : GLB

CHECKED : DGD

PROJ. NO : 15.5628

SCALE : 1" = 50'

DATE : SEPT. 2, 2016

BOUNDARY SURVEY
 Lands of
THE UNITED STATES OF AMERICA
 1130 CENTRAL AVENUE

TOWN OF COLONIE ALBANY COUNTY, NEW YORK

C.T. MALE ASSOCIATES
 Engineering, Surveying, Architecture & Landscape Architecture, D.P.C.
 50 CENTURY HILL DRIVE, LATHAM, NY 12110
 518.786.7400 * FAX 518.786.7299

SHEET 1 OF 1
 DWG. NO: 17-519

ONLY COPIES OF THIS MAP SIGNED IN RED INK AND EMBOSSED WITH THE SEAL OF AN OFFICER OF C.T. MALE ASSOCIATES OR A DESIGNATED REPRESENTATIVE SHALL BE CONSIDERED TO BE A VALID TRUE COPY.