

**SURVEYOR'S CERTIFICATE:**  
 TO: i. GENERAL SERVICES ADMINISTRATION  
 ii. COMMONWEALTH LAND TITLE INSURANCE COMPANY

THIS IS TO CERTIFY THAT THIS MAP OR PLAT AND THE SURVEY ON WHICH IT IS BASED WERE MADE IN ACCORDANCE WITH THE 2021 MINIMUM STANDARD DETAIL REQUIREMENTS FOR ALTA/NSPS LAND TITLE SURVEYS, JOINTLY ESTABLISHED AND ADOPTED BY ALTA AND NSPS, AND INCLUDES ITEMS 2, 4, 7(a), 7(b)(1), 8, & 13 OF TABLE A THEREOF. THE FIELD WORK WAS COMPLETED ON AUGUST 30, 2024.

DATE OF PLAT OR MAP: SEPTEMBER 5, 2024  
 NAME: GARY M. FAULHABER, LS  
 LICENSE DISTRICT OF COLUMBIA NO. #LS900735

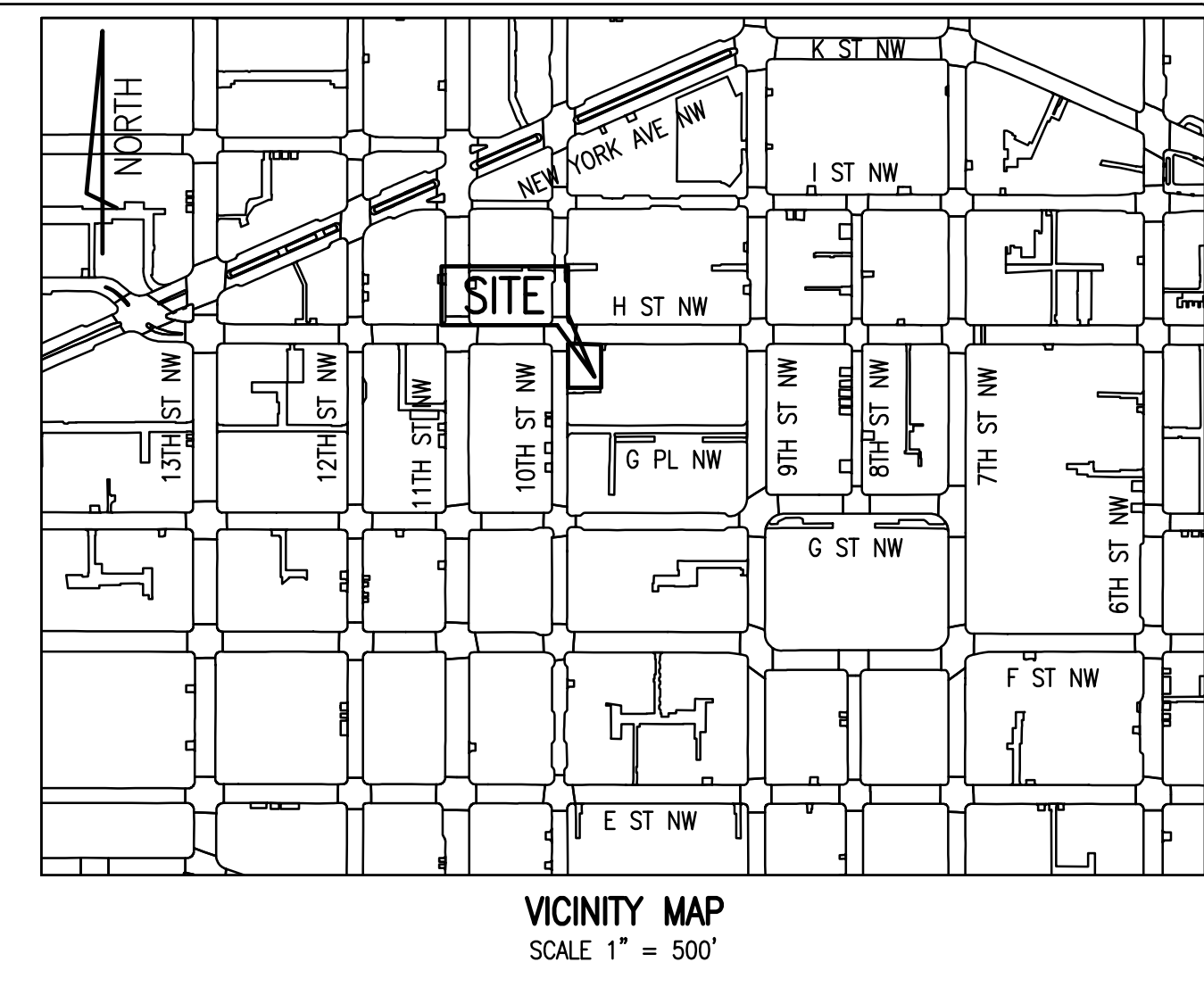
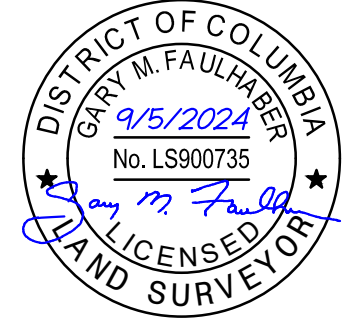

**TEXT LEGEND:**

- \* = DEGREES
- ' = MINUTES (OR FEET)
- " = SECONDS (OR INCHES)
- % = PERCENT
- # = NUMBER
- ⊙ = AT
- AC = AIR CONDITIONER
- APPROX = APPROXIMATE
- CL = CENTERLINE
- CONC = CONCRETE
- C&G = CURB & GUTTER
- DCSO = DC SURVEYOR'S OFFICE
- E = EAST
- FH = FIRE HYDRANT
- GM = GAS METER
- INSTR = INSTRUMENT
- LP = LIGHT POLE
- MH = MANHOLE
- MST = MEASUREMENT
- N = NORTH
- N/F = NOW OR FORMERLY
- REC = RECORD
- RCP = REINFORCED CONCRETE PIPE
- RELOC = RELOCATED
- RET = RETAINING
- S = SOUTH
- W = WEST
- WM = WATER METER
- WV = WATER VALVE

**GENERAL NOTES:**

- PROPERTY IS A&T LOT 840 IN SQUARE 375 AS ASSIGNED BY DC OFFICE OF TAX AND REVENUE AUGUST 9TH, 2024, AND BEING PORTIONS OF THE LANDS OF THE UNITED STATES OF AMERICA.
- AREA = 8,577 SQUARE FEET OR 0.19690 ACRES (RECORD)  
 AREA = 8,560 SQUARE FEET OR 0.19651 ACRES (MEASURED)
- THIS SURVEY IS PREPARED WITH REFERENCE TO A COMMITMENT FOR TITLE INSURANCE PREPARED BY COMMONWEALTH LAND TITLE INSURANCE COMPANY COMMITMENT NO. 10936, WITH AN EFFECTIVE DATE OF JUNE 26, 2001. THERE WERE NO SURVEY RELATED EXCEPTIONS LISTED IN SCHEDULE B, SECTION II IN SAID TITLE COMMITMENT.
- THE PROPERTY IS LOCATED IN [OTHER AREAS] ZONE X (AS DETERMINED TO BE OUTSIDE THE 0.2% ANNUAL CHANCE FLOODPLAIN) AS SHOWN ON THE FLOOD INSURANCE RATE MAP, DISTRICT OF COLUMBIA, WASHINGTON, D.C., PANEL 19 OF 100, MAP NUMBER 110001, WITH A MAP EFFECTIVE DATE OF SEPTEMBER 27, 2010.
- THERE IS NO PROVIDED ON-SITE PARKING.
- PROPERTY HAS ACCESS ALONG 10TH STREET N.W., & H STREET N.W., BOTH ARE PUBLIC STREETS.
- BOUNDARY INFORMATION SHOWN HEREON WAS OBTAINED FROM OFFICIAL CITY RECORDS, AND VERIFIED IN THE FIELD INSOFAR AS POSSIBLE. PROPERTY LINE DIMENSIONS FROM OFFICIAL RECORDS MAY NOT NECESSARILY AGREE WITH THE ACTUAL MEASURED DIMENSIONS. ALL PROPERTY LINES IN THE DISTRICT OF COLUMBIA ARE SUBJECT TO REVIEW AND APPROVAL BY THE OFFICE OF THE SURVEYOR, DISTRICT OF COLUMBIA. A "SURVEY TO MARK" PREPARED BY THE DISTRICT OF COLUMBIA REGISTERED LAND SURVEYOR AND VERIFIED BY THE OFFICE OF THE SURVEYOR IS REQUIRED TO ESTABLISH A FINAL BOUNDARY DETERMINATION AND CONFIGURATION FOR THIS PROPERTY. THIS SURVEY DOES NOT REFLECT A "SURVEY TO MARK". THE PROPERTY LINE REFLECTED ON THIS SURVEY IS NOT TO BE USED FOR ANY CONSTRUCTION STAKEOUT PURPOSES; A "SURVEY TO MARK" MUST BE APPROVED BY THE OFFICE OF THE SURVEYOR PRIOR TO BEGINNING ANY BUILDING DEMOLITION OR CONSTRUCTION OPERATIONS.

**LEGAL DESCRIPTION**

**A&T Lot 840**  
**Square 375**  
 (Assigned by DC Office of Tax and Revenue August 9th, 2024)  
 City of Washington  
 District of Columbia

All that certain tract or parcel of land lying and situated in Square numbered three-hundred, seventy-five (375) in the City of Washington, District of Columbia; being:

- Lots numbered one-hundred eight (108) through one-hundred fourteen (114), inclusive, as duly platted and recorded in Subdivision Book 10 at Page 179 among the records of the Office of the Surveyor for the District of Columbia;
- That portion of an alley closed as shown on plat recorded in Subdivision Book 91 at Page 30 among said Surveyor's records; and
- The westerly 1.10 feet of Lot numbered one-hundred twenty-three (123) as duly platted and recorded in Subdivision Book 152 at Page 177 among said Surveyor's records (former A&T Lot 838);

**LESS AND EXCEPT** that portion of the above-described tract or parcel set aside for the widening of a Public Alley as shown on plat recorded in Subdivision Book 137 at Page 147; said Public Alley being later closed as shown on plat recorded in Subdivision Book 189 at Page 173; all among said Surveyor's records.

All of the above being further described by metes and bounds as follows:  
**BEGINNING AT A POINT** at the intersection of the east line of 10th Street, N.W. (85 feet record width) and the south line of H Street, N.W. (90 feet record width);  
 Thence, departing said 10th Street, N.W. and running with said south line of H Street, N.W.:

- East, a distance of 77.10 feet to a point at the northwest corner of A&T Lot 839;
- Thence, departing said H Street, N.W. and running with the west line of said A&T Lot 839, crossing and including a portion of the above referenced record Lot 123;
- South, a distance of 111.25 feet to a point in the north line of the above referenced alley closed in Subdivision Book 189 at Page 73 among said records of the Office of the Surveyor for the District of Columbia;
- Thence, running with said north line of closed alley:
- West, a distance of 77.10 feet to a point in the aforementioned east line of 10th Street, N.W.;

Thence, departing said closed alley and running with said east line of 10th Street, N.W.:

- North, a distance of 111.25 feet to the **POINT OF BEGINNING**.

Containing a Record Area of 8,577 square feet of land more or less.

**NOTE:** At the date hereof, the above-described land is assigned on the Records of the Assessor for the District of Columbia for assessment and taxation (A&T) purposes as Lot eight-hundred, forty (840) in Square three-hundred, seventy-five (375).

**R. C. FIELDS & ASSOCIATES, INC.**  
 ENGINEERING • LAND SURVEYING • PLANNING  
 700 S. Washington Street, Suite 220  
 Alexandria, Virginia 22314  
 www.rcfields.com  
 (703) 549-6422

ALTA/NSPS LAND TITLE SURVEY  
**A&T LOT 840, SQUARE 375**  
 ASSIGNED BY DC OFFICE OF TAX AND REVENUE AUGUST 9TH, 2024  
 "THE DANIEL WEBSTER SCHOOL"  
 (940 H STREET, N.W.)  
 WASHINGTON, D.C.

DATE	REVISION

DRAWN: SPN/AA  
 SCALE: 1" = 10'  
 DATE: 09/05/2024

ALTA/NSPS LAND TITLE SURVEY

SHEET **1** OF **1**  
 FILE: **24-055**

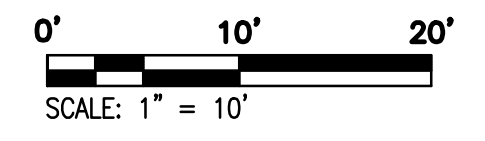

A:\2024\24055\UNO SURVEY\24055.dwg  
 Plt, Sep 06 2024 - 11:36:32am